

Application of 405nm Laser Diode in Haiti





Application of 405nm Laser Diode in Haiti



Ushio releases the world highest optical output power of

Single-mode LDs with a wavelength of 405 nm are widely used as a pickup light source for Blu-ray discs, and in recent years they have been widely

Global 405nm Laser Diodes Market 2025 by Manufacturers, Regions,

405nm Laser Diodes market is split by Type and by Application. For the period 2020-2031, the growth among segments provides accurate calculations and forecasts for consumption value by Type, and



405nm Laser Diodes for Medical Bio & Industrial , Shop

Our Violet 405nm laser diodes, based on GaN/InGaN technology, deliver near- UV performance for cutting-edge biomedical, optical, and industrial applications,



405 nm Laser Range

Our 405 nm laser range is designed to meet the demands of applications that require a short wavelength of 405 nm, offering output power levels ranging from 600 mW



405 nm laser (Diode; PM Fiber)

A small footprint and flexible fiber delivery make this laser easy to integrate into compact stereolithography machines. Other applications of this laser include fluorescence spectroscopy or



Arktis Laser , Scientific Lasers , Arktis Laser

Our 405nm Lasers are ideal for applications requiring a short wavelength of 405 nm and output power levels from 5 mW to 500 mW with a high level of long-term output power stability. These 405 nm

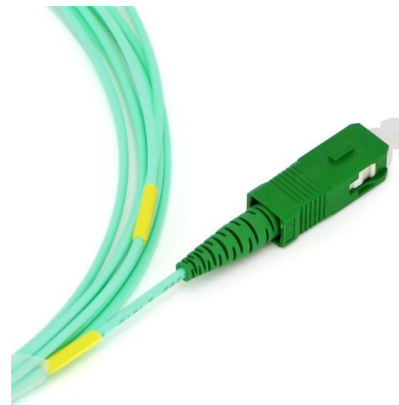

405nm Laser Diodes

Its use in high volume consumer product applications forced economies of scale which make this laser diode wavelength affordable and simple to procure. However, relative to red laser diodes, 405nm





High Power 405nm Laser Diode, 1W Output

This multimode 405nm laser diode delivers up to 1 Watt output power. Applications include biological and medical systems, measurement, and 3D-printer applications.



Ushio has launched longer-life, 405 nm, 600 mW

There is also increasing demand for laser diodes in the 405 nm band, which are commonly used as light sources in biomedical, measurement, and 3D

405nm laser diode, 150mW, from Integrated Optics

405nm Fiber-Coupled Laser Diode Module, Turn-Key Operation Violet 405 nm laser with SMA output is a very compact high performance laser source for multimode



Ushio launches longer-life, 405nm, 600mW electrostatic-resistant

There is increasing demand for laser diodes in the 405nm band which are commonly used as light sources in biomedical, measurement, and 3D printing applications which require further



DIODE LASER SYSTEMS

DIODE LASER SYSTEMS - 405 nm RLTM DL-405 series Operation Mode: CW Seperate laser head, cooled by TEC Power supply included, fixed output power,



Diodes Articles

In this article, we explore the 405 nm laser wavelength color, its properties, and applications. Laser diodes are semiconductor devices that emit light when an electric current is

405 nm SLM Laser

Description High-performance 405 nm single longitudinal mode (SLM) laser, designed with precision for applications in Raman scattering and fluorescence



405nm Laser Diode - BeamQ Laser

The most common blue lasers are the diode lasers used in Blu-ray applications, which emit 405 nm "violet" light, which is a short enough wavelength to cause



405nm Laser Diode 4

Features High output power of 30W
400um/0.22NA multimode optical fiber Center
wavelength 400~405nm Applications LDI Medical
Application

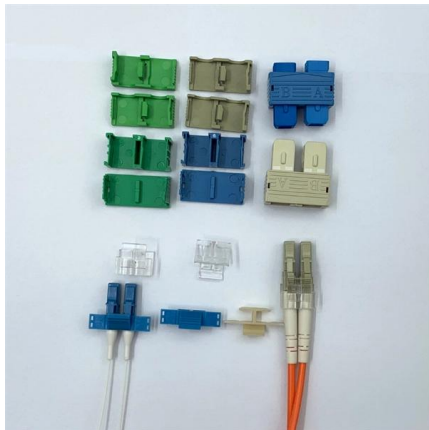

405 nm Lasers

405 nm Lasers This is 405 nm coherent diode laser with power ranging up to 130 mW in free-space. Violet laser radiation is particularly useful in direct curing of

National Center for Biotechnology Information

Hier sollte eine Beschreibung angezeigt werden, diese Seite lässt dies jedoch nicht zu.

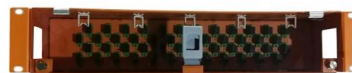

405nm 150mW Laser Diode, HL40041MG by USHIO

Product Overview 405nm, 150mW Violet Diode Laser This single mode 405nm laser diode delivers up to 150mW output power. The industry standard 5.6mm TO-can



Studies on 405nm blue-violet diode laser with external grating cavity

Spectroscopy applications of free-running laser diodes (LD) are greatly restricted as its broad band spectral emission. And the power of a single blue-violet LD is around several hundred

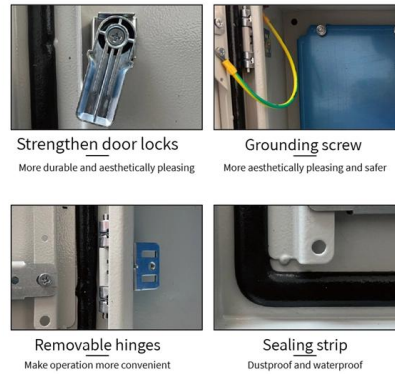

405 nm OEM Violet-blue Diode Laser OEM-HD-405

Share this: OEM-HD-405 series violet-blue diode laser module at 405nm features ultra compact, long lifetime, low cost and easy operating.

High Power 976 nm Spectrum Stabilized Multi-Mode Pump Laser

RPMC offers 405 nm single-mode lasers in our D-Type OEM module, turnkey R-Type or turnkey Tethered Head H-Type. Available in 14-pin BF upon request. Lasing wavelength can be accurately

More durable and robust

The outer layer is made of environmentally friendly PVC, which is soft and elastic. It can be stretched without damage, so you can use it with confidence.

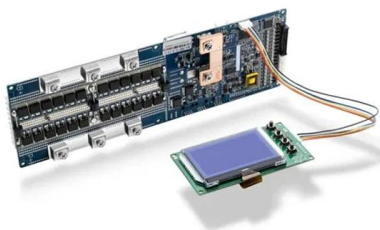
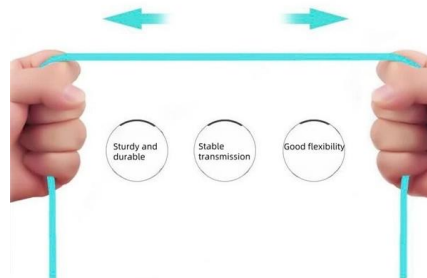

Ushio has launched longer-life, 405 nm, 600 mW

HL40173MG, HL40175MG laser diodes offer increased voltage protection for biomedical, measurement, and 3D printing applications Ushio has launched its



The latest products for diode lasers in 2024 , Electro Optics

The ability of diode lasers to convert electrical energy directly into laser light has led them to become an increasingly popular choice in a number of industries and applications, where. They may provide a



HL40213MG

This diode is engineered to maintain stable beam quality over a wide operating temperature range of -5°C to 85°C , making it suitable for demanding industrial

Diodes Articles

Articles covering the technical workings and details of semiconductor laser diodes, their uses, manufacture, and more.



Laser Diode Modules at 405 nm

Having been used for applications in the chemical and medical industries, the 405 nm FLEXPPOINT[®] laser module series is now available with



405 nm Laser

Polarization-maintaining fiber-coupled 405 nm diode laser features extreme brightness combined with perfect beam shape and virtually perfect Gaussian

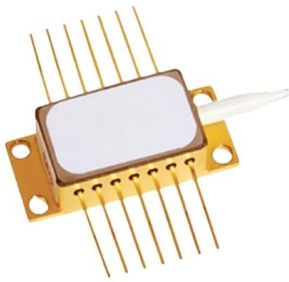

405 nm Collimated Diode Laser System

Description 405 nm Violet Collimated Diode Laser System The LRD-0405 Series of Collimated Diode (Semiconductor) Lasers are ideal for applications requiring a

Contact Us

For datasheets, pricing, or custom high-speed optical interconnect solutions, please visit:
<https://syropy.com.pl>